

Engineering Specification

Job Name _____
 Job Location _____
 Engineer _____
 Approval _____
 Tag _____

Contractor _____
 Approval _____
 Contractor's P.O. No. _____
 Representative _____

CO-440-RD

Expandable Line Cleanout with Wall Access Cover

Specification

Watts CO-440-RD wall cleanout with two-piece expandable cleanout plug, stainless steel access cover, and vandal proof stainless steel screw.



PIPE SIZE	COVER SIZE
1 1/2"(38)	5"(127)
2"(51)	5"(127)
3"(76)	7"(178)
4"(102)	7"(178)
6"(152)	10"(254)

NOTICE

The information contained herein is not intended to replace the full product installation and safety information available or the experience of a trained product installer. You are required to thoroughly read all installation instructions and product safety information before beginning the installation of this product.

Please refer to watts.com for BAA information on specific models.

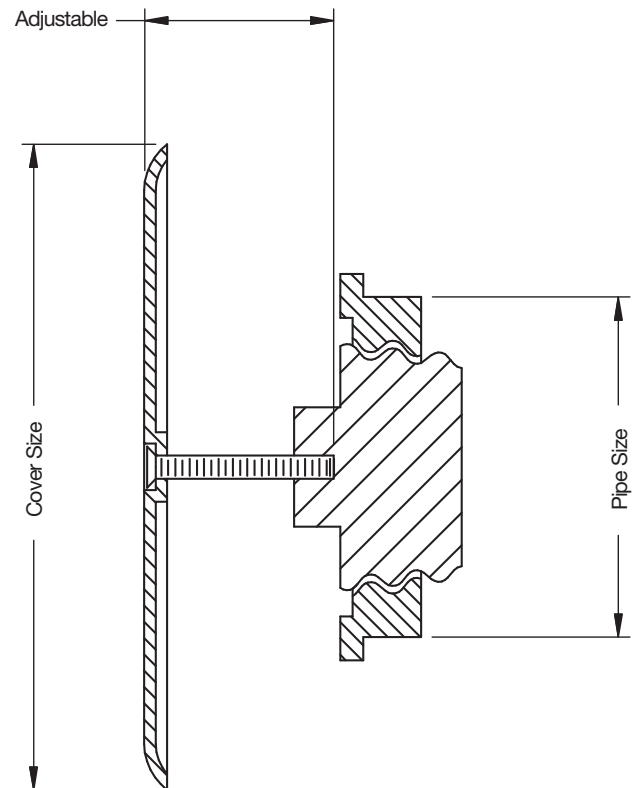

Watts product specifications in U.S. customary units and metric are approximate and are provided for reference only. For precise measurements, please contact Watts Technical Service. Watts reserves the right to change or modify product design, construction, specifications, or materials without prior notice and without incurring any obligation to make such changes and modifications on Watts products previously or subsequently sold.



USA: T: (800) 338-2581 • F: (828) 248-3929 • Watts.com
Canada: T: (888) 208-8927 • F: (905) 481-2316 • Watts.ca
Latin America: T: (52) 55-4122-0138 • Watts.com
 ES-WD-CO-440-RD 2138