

## GENERAL GUIDELINES

- **A 12 VOLT DC POWER SUPPLY MUST BE USED WITH sempriaLED FIXTURES!**
- All wiring must meet NEC<sup>®</sup> or local codes.
- 20/2 solid wire is recommended from power supply to fixtures and between fixtures.  
*(If 20/2 solid wire is not available, 20/2 stranded wire may also be used. Tin ends of wire if possible.)*
- A maximum of 60 watts of sempriaLED Lighting is allowed on a zone.
- Limit wire length to 30 feet from power supply to lights.
- Place switches on the 120 volt side of the power supply (12 volt DC).
- De-burr all cut WireWay edges to ensure wire safety.
- If other than Task specified dimmers are desired, call Task Lighting for instructions.
- **Improper installation or applying improper voltage to fixture will void warranty. See TaskLighting.com for full warranty info.**

## POWER SUPPLY (12 volt DC) LOCATIONS

- Some power supplies may be conveniently concealed within our TR Series Angle Power Strip or Lighted Power Strip.
- A sink base or the top of a cabinet are other common power supply locations.
- Power Supply must be accessible.
- **DO NOT LOCATE POWER SUPPLY IN ATTIC.**

## PRE-WIRING

Run separate wire from power supply (12 volt DC) location to each zone. When total wattage of sempriaLED fixtures in zone exceeds 60 watts, use a second power supply and run additional 20/2 solid wire for another zone. Length of wire from power supply to first fixture in each zone is not to exceed 30 feet. Wiring may start at either end of fixture. (Option: separate wire may be run from power supply to each fixture.)

## SEE POWER SUPPLY INSTALLATION INSTRUCTIONS FOR INSTALLING POWER SUPPLY

1. Cut SG9-WW WireWay Base the length from wire entry location (at back of cabinet) to the front of cabinet. Miter the corner or use SG9-WW-MJ12 (12" miter piece) to turn the corner. Deburr all cut edges to ensure wire safety.



4. Cut wire to fit between adjacent fixtures. Insert wires into terminal blocks, maintaining polarity (RED wire to RED terminal, BLACK wire to BLACK terminal.) Maintain polarity or fixtures will not work.



2. Cut WireWay Base to fit full length of cabinet face. Deburr cut edges. Using screws provided, secure Base to bottom of cabinet every 12". (When wiring between adjacent cabinets, drill 1/4" hole through end panels.)



5. Snap lens onto fixture. Position fixture in center of cabinet and snap into WireWay Base.

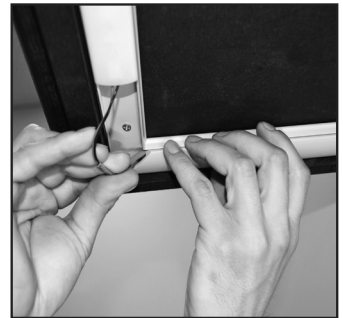

3. Strip 1/4" insulation from driver wires. Push RED solid wire straight into terminal block with RED mark. Push BLACK solid wire straight into terminal block with BLACK mark. (20/2 solid wire is recommended. If using 20/2 stranded wire, ends must be tinned. Depress terminal block tab with ball point pen and insert wire.)

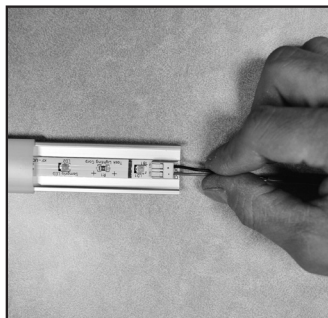

6. Cut WireWay Cover (or miter piece) to fit exposed Base. Deburr cut WireWay edges. Snap into Base.

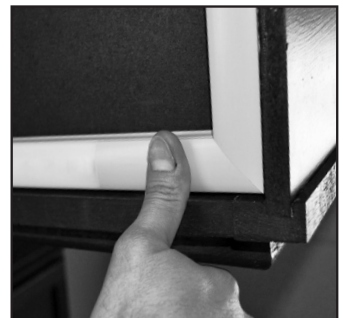

#### OPTION: Installing sempriaLED Fixtures Without WireWay

Use mounting channel supplies with fixture. Use screws provided to secure mounting channel to underside at face of cabinet. Follow step 3 instructions. Position fixture in channel and snap into place.