

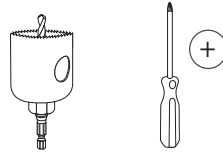

L-MS-CL-1BA-30

Tools Needed



Mini Square Series Puck Light

Part Number	Description and Use	Dimensions
L-MS-CL-1BA-Temp	Mini Square Puck Light for Surface or Recess Mount	1-1/4" x 7/8"

NOTE

Mini Square Puck Lights are **NOT DIMMABLE**
See pages 20-23 for wiring power supply to puck light.

Surface Mount

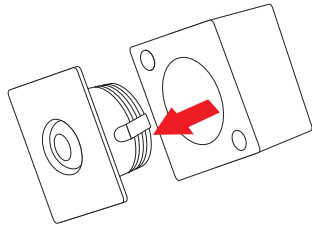

1. Remove Mini Puck Light from housing by grasping the trim and firmly pulling.

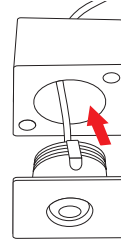

2. Route fixture wires through center of housing toward power supply location; position wires in housing notch.

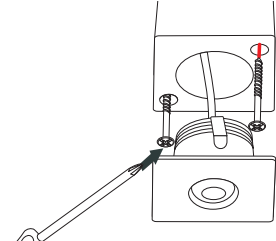

3. Secure housing to mounting surface with 2 screws, included.

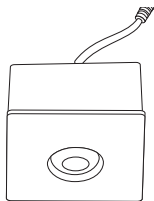

4. Snap Mini Puck trim into housing.

Recess Mount

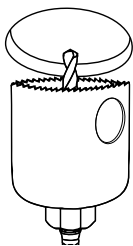

1. Use a hole saw and cut a 1-3/16" hole through mounting surface.

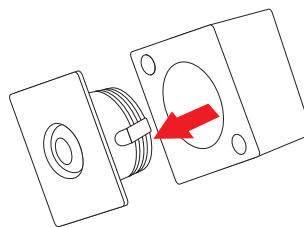

2. Remove Mini Puck Light from housing by grasping the trim and firmly pulling.

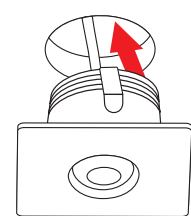

3. Route fixture wires through the hole toward power supply location.

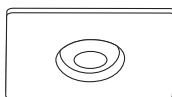

4. Snap Mini Puck trim into the hole.