

# E160

**Model number:**

103676

**Dimensions:** 60" x 37" x 79"

**Installation:** Alcove

**Material:** Acrylic



## Standard Features:

- Left-, Right-, 2-seat and no-seat options
- Comfort height foot ledge (on 1-seat and no-seat models)
- Large shelving
- Center drain
- 6 in. threshold

## Product characteristics:

- Made in North America
- Cast Acrylic
- One-Piece Unit

## Warranty:

25 Years

## Standard colors:



White (001)

## Certifications

MAAX products adhere to one or more of the following certifications:



# E160

**Model number:**

103676

**Dimensions:** 60" x 37" x 79"

**Installation:** Alcove

**Material:** Acrylic

STANDARD

## Dimensions:

60 x 37 1/4 x 79 1/4 in.  
(1524 x 946.15 x 2012.95 mm)

## Weight:

179 lbs - 81.193 kg

## Shape:

Rectangular

## Pieces:

1

## Drain location:

No seat, center drain

Two seats, center drain

Left seat, center drain

Right seat, center drain

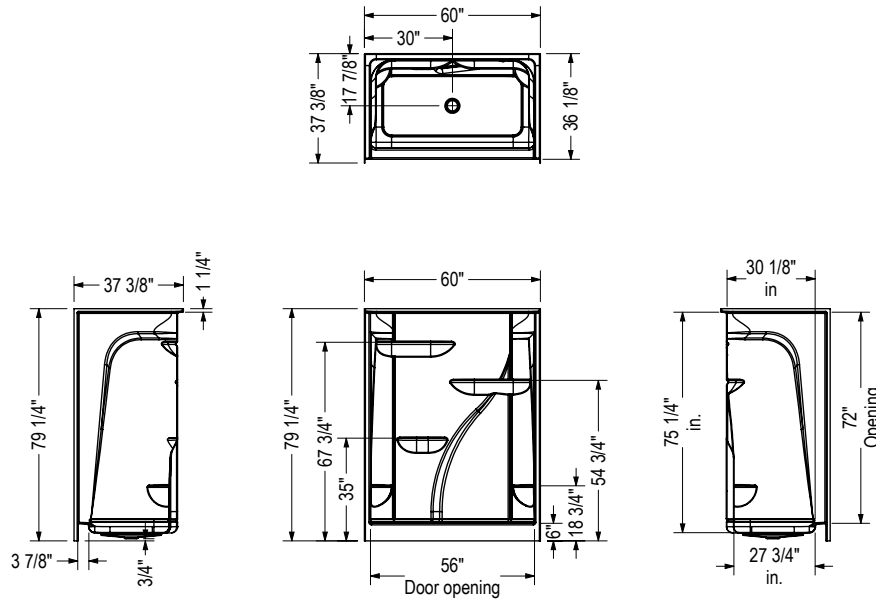

All dimensions are approximate. Structure measurements must be verified against the unit to ensure proper fit.

Project:

Contractor:

Representative:

Date:

Tel:

Notes: