

# KINGSTON

KITCHEN & BATH

## INSTALLATION INSTRUCTIONS

### Extension Tube

This Item is intended to be used as a tailpiece extension.

### Instructions:

1. Measure and cut to the desired length
2. Place rubber washer over the top opening (larger diameter)
3. Lightly thread nut and insert into the sinks drain tailpiece
4. Tighten using a pipe or spud wrench.
5. Insert other end into "P" trap and tighten the compression washer.
6. Run water to test for leaks

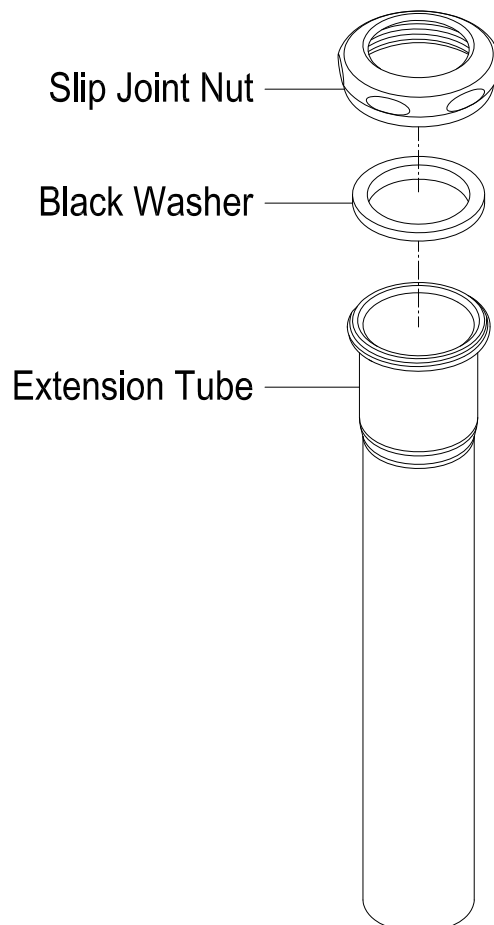

[www.kingstonbrass.com](http://www.kingstonbrass.com)

TOLL-FREE CUSTOMER SERVICE: 1-877-2-KBRASS

TECHNICAL SUPPORT E-mail: [service@kingstonbrass.com](mailto:service@kingstonbrass.com)

12775 Reservoir Street, Chino, CA 91710